

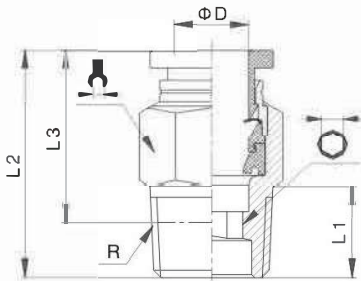

PC-R

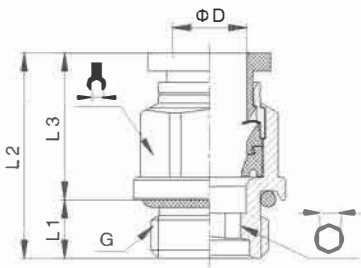

Model	L2	L2	L2	L2	L2		
PC4-M5	4	M5	3.5	20	16.5	10	2
PC4-M6		M6	4	20.5	16.5	10	2.5
PC4-01		R1/8	7.5	19.5	15.5	10	3
PC4-02		R1/4	10	19.5	13.5	14	3
PC4-03		R3/8	10.5	20.5	14	17	3
PC6-M5	6	M5	3.5	21	17.5	12	2
PC6-M6		M6	4	21.5	17.5	12	2.5
PC6-01		R1/8	7.5	21	17	12	4
PC6-02		R1/4	10	23	17	14	4
PC6-03		R3/8	10.5	21	14.5	17	4
PC6-04	R1/2	13.5	25	16.5	21	4	
PC8-01	8	R1/8	7.5	26.5	22.5	14	5
PC8-02		R1/4	10	25	19	14	6
PC8-03		R3/8	10.5	21.5	15	17	6
PC8-04		R1/2	13.5	25.5	17.5	21	6
PC10-01	10	R1/8	7.5	29	25	17	5
PC10-02		R1/4	10	31	25	17	6
PC10-03		R3/8	10.5	27	20.5	17	8
PC10-04		R1/2	13.5	26.5	18	21	8
PC10-06		R3/4	15	28	18.5	27	8
PC12-01	12	R1/8	7.5	31.5	27.5	21	5
PC12-02		R1/4	10	34	28	21	6
PC12-03		R3/8	10.5	29.5	23	21	8
PC12-04		R1/2	13.5	32.5	24.5	21	10
PC12-06		R3/4	15	29	19.5	27	10
PC14-02	14	R1/4	10	34.5	28.5	22	6
PC14-03		R3/8	10.5	35	28.5	22	10
PC14-04		R1/2	13.5	33	24.5	22	10
PC14-06		R3/4	15	29.5	20	27	10
PC16-02	16	R1/4	10	36	30	24	6
PC16-03		R3/8	10.5	37	30.5	24	10
PC16-04		R1/2	13.5	37	28.5	24	12
PC16-06		R3/4	15	29.5	20	27	12

PC-G



Model	L2	L2	L2	L2	L2		
PC4-G01	4	G1/8	5.5	19.5	14	10	3
PC4-G02		G1/4	6.5	19.5	13	12	3
PC6-G01	6	G1/8	5.5	20.5	15	12	4
PC6-G02		G1/4	6.5	21.5	15	12	4
PC6-G03		G3/8	7.5	21	13.5	16	4
PC6-G04		G1/2	10	23.5	13.5	17	4
PC8-G01	8	G1/8	5.5	26	20.5	14	5
PC8-G02		G1/4	6.5	23	16.5	14	6
PC8-G03		G3/8	7.5	24	16.5	16	6
PC8-G04		G1/2	10	25	15	19	6
PC10-G01	10	G1/8	5.5	28.5	23	17	5
PC10-G02		G1/4	6.5	29.5	23	17	6
PC10-G03		G3/8	7.5	26	18.5	17	8
PC10-G04		G1/2	10	26	16	19	8
PC12-G02	12	G1/4	6.5	31.5	25	20	6
PC12-G03		G3/8	7.5	32.5	25.5	20	8
PC12-G04		G1/2	10	30.5	20.5	20	10
PC14-G02		14	G1/4	6.5	32	25.5	22
PC14-G03	G3/8		7.5	33.5	26	22	10
PC14-G04	16	G1/2	10	31	21	24	10
PC16-G02		G1/4	6.5	33	26.5	24	6
PC16-G03		G3/8	7.5	34.5	27.5	24	10
PC16-G04		G1/2	10	37	27	24	12

QUICK CONNECTING TUBE FITTINGS

POC-R

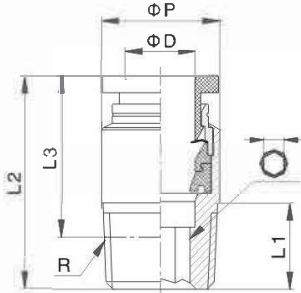

Model	Ø	Ø	Ø	Ø	Ø	Ø	Ø
POC4-M5	4	M5	3.5	20	16.5	10	2
POC4-M6		M6	4	20.5	16.5	10	2.5
POC4-01		R1/8	7.5	19.5	15.5	10	3
POC4-02		R1/4	10	19.5	13.5	14	3
POC6-M5	6	M5	3.5	21	17.5	12	2
POC6-M6		M6	4	21.5	17.5	12	2.5
POC6-01		R1/8	7.5	21	17	12	4
POC6-02		R1/4	10	23	17	14	4
POC6-03	R3/8	10.5	21	14.5	17	4	
POC8-01	8	R1/8	7.5	26.5	22.5	14	5
POC8-02		R1/4	10	25	19	14	6
POC8-03		R3/8	10.5	21.5	15	17	6
POC8-04		R1/2	13.5	25.5	17.5	21	6
POC10-01	10	R1/8	7.5	29	25	17	5
POC10-02		R1/4	10	31	25	17	6
POC10-03		R3/8	10.5	27	20.5	17	8
POC10-04		R1/2	13.5	26	18	21	8
POC12-02	12	R1/4	10	34	28	21	6
POC12-03		R3/8	10.5	29.5	23	21	8
POC12-04		R1/2	13.5	32.5	24.5	21	10
POC16-03		R3/8	10.5	37	30.5	24	10
POC16-04	16	R1/2	13.5	37	28.5	24	12

PC-NPT

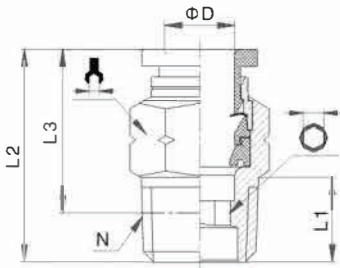

Model	1/2	N	L3	L3	L3		
PC1/8-U10	1/8	10-32UNF	3.5	20	16.5	7/16	2
PC1/8-N01		NPT1/8	7.5	19.5	15.5	7/16	2.4
PC1/8-N02		NPT1/4	10	19.5	13.5	9/16	2.4
PC5/32-U10	5/32	10-32UNF	3.5	20	16.5	7/16	2
PC5/32-N01		NPT1/8	7.5	19.5	15.5	7/16	3.2
PC5/32-N02		NPT1/4	10	19.5	13.5	9/16	3.2
PC3/16-U10	3/16	10-32UNF	3.5	20	16.5	7/16	2
PC3/16-N01		NPT1/8	7.5	19.5	15.5	7/16	4
PC3/16-N02		NPT1/4	10	19.5	13.5	9/16	4
PC1/4-U10	1/4	10-32UNF	3.5	21	17.5	1/2	2
PC1/4-N01		NPT1/8	7.5	21	17	1/2	4
PC1/4-N02		NPT1/4	10	23	17	9/16	4
PC1/4-N03		NPT3/8	10.5	21	15	11/16	4
PC5/16-N01	5/16	NPT1/8	7.5	26.5	22.5	9/16	5.6
PC5/16-N02		NPT1/4	10	25	19.5	9/16	6.4
PC5/16-N03		NPT3/8	10.5	21.5	15.5	11/16	6.4
PC5/16-N04		NPT1/2	13.5	25.5	17.5	7/8	6.4
PC3/8-N01	3/8	NPT1/8	7.5	29	22.5	11/16	5.6
PC3/8-N02		NPT1/4	10	31	25	11/16	6.4
PC3/8-N03		NPT3/8	10.5	27	21	11/16	8
PC3/8-N04		NPT1/2	13.5	26	18	7/8	8
PC1/2-N02	1/2	NPT1/4	10	34	28	7/8	6.4
PC1/2-N03		NPT3/8	10.5	30.5	24	7/8	9.6
PC1/2-N04		NPT1/2	13.5	32.5	24.5	7/8	9.6

PCF-R

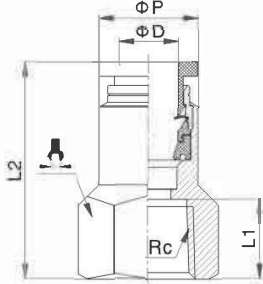

Model	⌀	⌀	⌀	⌀	⌀	⌀
PCF4-M5	4	M5	5	21.5	10	10
PCF4-M6		M6	5	21.5	10	10
PCF4-01		R1/8	8.5	24.5	10	14
PCF4-02		R1/4	11	27	10	17
PCF6-M5	6	M5	5	22	12	12
PCF6-M6		M6	5	22	12	12
PCF6-01		R1/8	8.5	25.5	12	14
PCF6-02		R1/4	11	28	12	17
PCF6-03	R3/8	11.5	28.5	12	20	
PCF8-01	8	R1/8	8.5	27.5	14	14
PCF8-02		R1/4	11	30	14	17
PCF8-03		R3/8	11.5	30.5	14	20
PCF8-04		R1/2	14	33	14	24
PCF10-01	10	R1/8	8.5	30	17	17
PCF10-02		R1/4	11	32.5	17	17
PCF10-03		R3/8	11.5	33	17	20
PCF10-04		R1/2	14	35.5	17	24
PCF12-02	12	R1/4	11	35	20	20
PCF12-03		R3/8	11.5	35.5	20	20
PCF12-04		R1/2	14	38	20	24
PCF14-03	14	R3/8	11.5	36	22	22
PCF14-04		R1/2	14	38.5	22	24
PCF16-03	16	R3/8	11.5	37	24	24
PCF16-04		R1/2	14	39.5	24	24

PCF-G

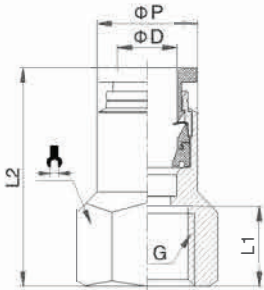

Model	⌀	G	⌀	⌀	⌀	⌀
PCF4-G01	4	G1/8	8.5	24.5	10	14
PCF4-G02		G1/4	11	27	10	17
PCF6-G01	6	G1/8	8.5	25.5	12	14
PCF6-G02		G1/4	11	28	12	17
PCF6-G03		G3/8	11.5	28.5	12	20
PCF8-G01	8	G1/8	8.5	27.5	14	14
PCF8-G02		G1/4	11	30	14	17
PCF8-G03		G3/8	11.5	30.5	14	20
PCF8-G04		G1/2	14	33	14	24
PCF10-G01	10	G1/8	8.5	30	17	17
PCF10-G02		G1/4	11	32.5	17	17
PCF10-G03		G3/8	11.5	33	17	20
PCF10-G04		G1/2	14	35.5	17	24
PCF12-G02	12	G1/4	11	35	20	20
PCF12-G03		G3/8	11.5	35.5	20	20
PCF12-G04		G1/2	14	38	20	24
PCF14-G03		G3/8	11.5	36	22	22
PCF14-G04	14	G1/2	14	38.5	22	24
PCF16-G03	16	G3/8	11.5	37	24	24
PCF16-G04		G1/2	14	39.5	24	24

PMF-R

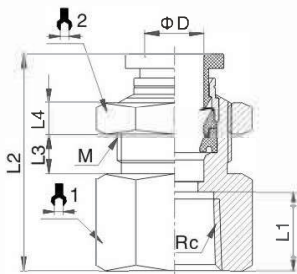

Model	ϕD	L3	L3	L3	L3	L3	M		
PMF4-01	4	R1/8	8.5	24.5	5	3.5	M12*1.0	14	14
PMF4-02		R1/4	11	27	8	3.5	M12*1.0	17	14
PMF6-01	6	R1/8	8.5	25.5	5.5	4	M14*1.0	17	17
PMF6-02		R1/4	11	28.5	5.5	4	M14*1.0	17	17
PMF6-03		R3/8	11.5	29	5.5	4	M14*1.0	20	17
PMF8-01	8	R1/8	8.5	27.5	5.5	4.5	M16*1.0	19	19
PMF8-02		R1/4	11	30	5.5	4.5	M16*1.0	19	19
PMF8-03		R3/8	11.5	30.5	5.5	4.5	M16*1.0	20	19
PMF8-04		R1/2	14	33	5.5	4.5	M16*1.0	24	19
PMF10-02	10	R1/4	11	32.5	7	5	M18*1.0	21	21
PMF10-03		R3/8	11.5	33	7	5	M18*1.0	21	21
PMF10-04		R1/2	14	35.5	7	5	M18*1.0	24	21
PMF12-02	12	R1/4	11	35	9	5	M22*1.0	27	27
PMF12-03		R3/8	11.5	35.5	9	5	M22*1.0	27	27
PMF12-04		R1/2	14	38	9	5	M22*1.0	27	27

PMF-G

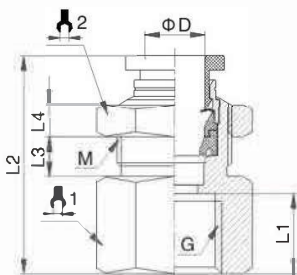

Model	ϕD	G	L1	L2	G	L4	M		
PMF4-G01	4	G1/8	8.5	24.5	5	3.5	M12*1.0	14	14
PMF4-G02		G1/4	11	27	5	3.5	M12*1.0	17	14
PMF6-G01	6	G1/8	8.5	25.5	5.5	4	M14*1.0	17	17
PMF6-G02		G1/4	11	28.5	5.5	4	M14*1.0	17	17
PMF6-G03		G3/8	11.5	29	5.5	4	M14*1.0	20	17
PMF8-G01	8	G1/8	8.5	27.5	5.5	4.5	M16*1.0	19	19
PMF8-G02		G1/4	11	30	5.5	4.5	M16*1.0	19	19
PMF8-G03		G3/8	11.5	30.5	5.5	4.5	M16*1.0	20	19
PMF8-G04		G1/2	14	33	5.5	4.5	M16*1.0	24	19
PMF10-G02	10	G1/4	11	32.5	7	5	M18*1.0	21	21
PMF10-G03		G3/8	11.5	33	7	5	M18*1.0	21	21
PMF10-G04		G1/2	14	35.5	7	5	M18*1.0	24	21
PMF12-G02	12	G1/4	11	35	9	5	M22*1.0	27	27
PMF12-G03		G3/8	11.5	35.5	9	5	M22*1.0	27	27
PMF12-G04		G1/2	14	38	9	5	M22*1.0	27	27

PM

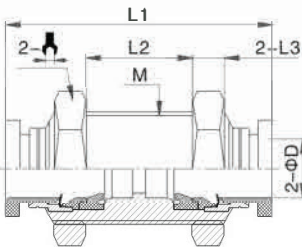

Model	ϕD	M	L1	L2	L3	
PM4	4	M12*1.0	31	13	3.5	14
PM6	6	M14*1.0	32.5	13	4	17
PM8	8	M16*1.0	37	15	4.5	19
PM10	10	M18*1.0	42	18.5	5	21
PM12	12	M22*1.0	46	20	5	27
PM14	14	M24*1.0	47	20	5.5	30
PM16	16	M26*1.0	49	22	6	32
PM5/32	5/32	M12*1.0	31	13	3.5	14
PM3/16	3/16	M12*1.0	31	13	3.5	14
PM1/4	1/4	M14*1.0	32.5	13	4	17
PM5/16	5/16	M16*1.0	37	15	4.5	18
PM3/8	3/8	M18*1.0	42	18.5	5	21
PM1/2	1/2	M22*1.0	46	20	5	27

PC-P

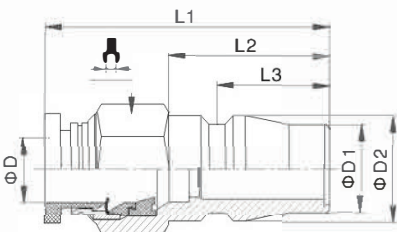

Model	ϕD	$\phi 1$	$\phi 2$	L1	L2	L3	
PC4-P	4	11	13	33.5	20	14	14
PC6-P	6	11	13	34.5	20	14	14
PC8-P	8	11	13	35.5	20	14	14
PC10-P	10	11	13	37.5	20	14	17
PC12-P	12	11	13	44	20	14	21
PC14-P	14	11	13	44	20	14	22
PC16-P	16	11	13	46	20	14	24

NPBT

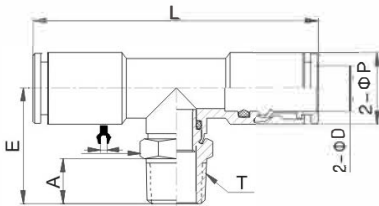

Model	ΦD	T	ØAP	E	E	ØAP	
NPBT04-M5	4	M5X0.8	3.5	47	15.8	10	10
NPBT04-01		R01	8		19.3		10
NPBT04-02		R02	10		21.8		14
NPBT06-M5	6	M5X0.8	3.5	49.4	16.8	12	10
NPBT06-01		R01	8		20.4		14
NPBT06-02		R02	10		22.9		14
NPBT08-01	8	R01	8	55.4	22.5	14	12
NPBT08-02		R02	10		24.5		14
NPBT08-03		R03	11		25.5		17
NPBT08-04		R04	14		29		21
NPBT10-01	10	R01	8	63.4	23.5	16	14
NPBT10-02		R02	10		25.5		17
NPBT10-03		R03	11		26.5		21
NPBT10-04		R04	14		30		21
NPBT12-02	12	R02	10	64.4	26.7	18	17
NPBT12-03		R03	11		27.7		21
NPBT12-04		R04	14		31.2		21
NPBT16-03	16	R03	11	74	29.8	22	21
NPBT16-04		R04	14		32.8		21

NPBT-G

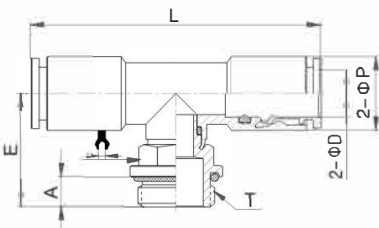

Model	ΦD	T	ØAP	E	E	ØAP	
NPBT04-G01	4	G01	5.5	47	19.3	10	10
NPBT04-G02		G02	6.5		20.3		10
NPBT06-G01	6	G01	5.5	49.4	20.4	12	10
NPBT06-G02		G02	6.5		21.4		10
NPBT08-G01	8	G01	5.5	55.4	21	14	12
NPBT08-G02		G02	6.5		23		
NPBT08-G03		G03	7.5		23.5		
NPBT08-G04		G04	10		27.5		
NPBT10-G01	10	G01	5.5	63.4	22	16	14
NPBT10-G02		G02	6.5		24		
NPBT10-G03		G03	7.5		24.5		
NPBT10-G04		G04	10		28.5		
NPBT12-G02	12	G02	6.5	64.4	24.7	18	17
NPBT12-G03		G03	7.5		25.7		
NPBT12-G04		G04	10		29.7		
NPBT16-G03	16	R03	7.5	74	28.8	22	21
NPBT16-G04		R04	10		31.3		24